

TTHA Building Project Update.

Dear Staff, Residents & Family:

The building works are commencing! We have now confirmation for the following works:

- Boundary Fencing – Erect Thursday 4th October 2018
- Site Shed Delivery – Thursday the 4th October 2018
- Temp Services to Site Amenities – Starting Friday 5th October 2018
- Remove Trees – Monday 8th to the Wednesday the 10th October 2018
- Remove/ Abolish any existing services 10th & 1th October 2018
- Clear Site/ Site Cut – Tentative Booking Monday 15th October 2018

It is important that there are no cars parked on the lawn areas or under the trees as the builders will be placing the tree protection and fencing in these areas.

I also recommend that no cars be parked along Elizabeth Street to make way for trucks and emergency vehicles.

A new front entrance will be created along Elizabeth Street as the existing entrance will be blocked for the building works.

Staff parking allocation is available behind the Tabulam wing, and on the grass area near the hall. I have highlighted the area on the map in green.

Visitors are welcomed to park near the front entrance of the home, however the parking spaces available will reduce.

If there are any issues or concerns, please do not hesitate to contact me on (03) 8720 1333 or e-mail at ttha@ttha.org.au

We will provide you with regular updates on our progress and thank you for your cooperation.

Regards,
Eva Simo
CEO

- FIREPLAN - SITE**
- SPRINKLER BOOSTER CONNECTION
 - SPRINKLER CONTROL VALVE
 - FIRE HYDRANT
 - EXITS
 - EMERGENCY EVACUATION AREA
 - GAS SHUT-OFF VALVE
 - GAS METER
 - ROADWAY ENTRY
 - WATER CONTROL VALVE

- BUILDINGS LEGEND**
- TABULAM
 - OTTO LOBERT HEIM
 - WAGNERIA
 - ALTERSHEIM
 - ELECTRICAL SUBSTATION, PLANT ROOM, MAINTENANCE CARPORTS
 - INDEPENDANT LIVING UNITS
 - TEMPLAR COMMUNITY HALL
 - TEMPLAR CENTRE CHAPEL
 - TEMPLAR TENNIS CLUB

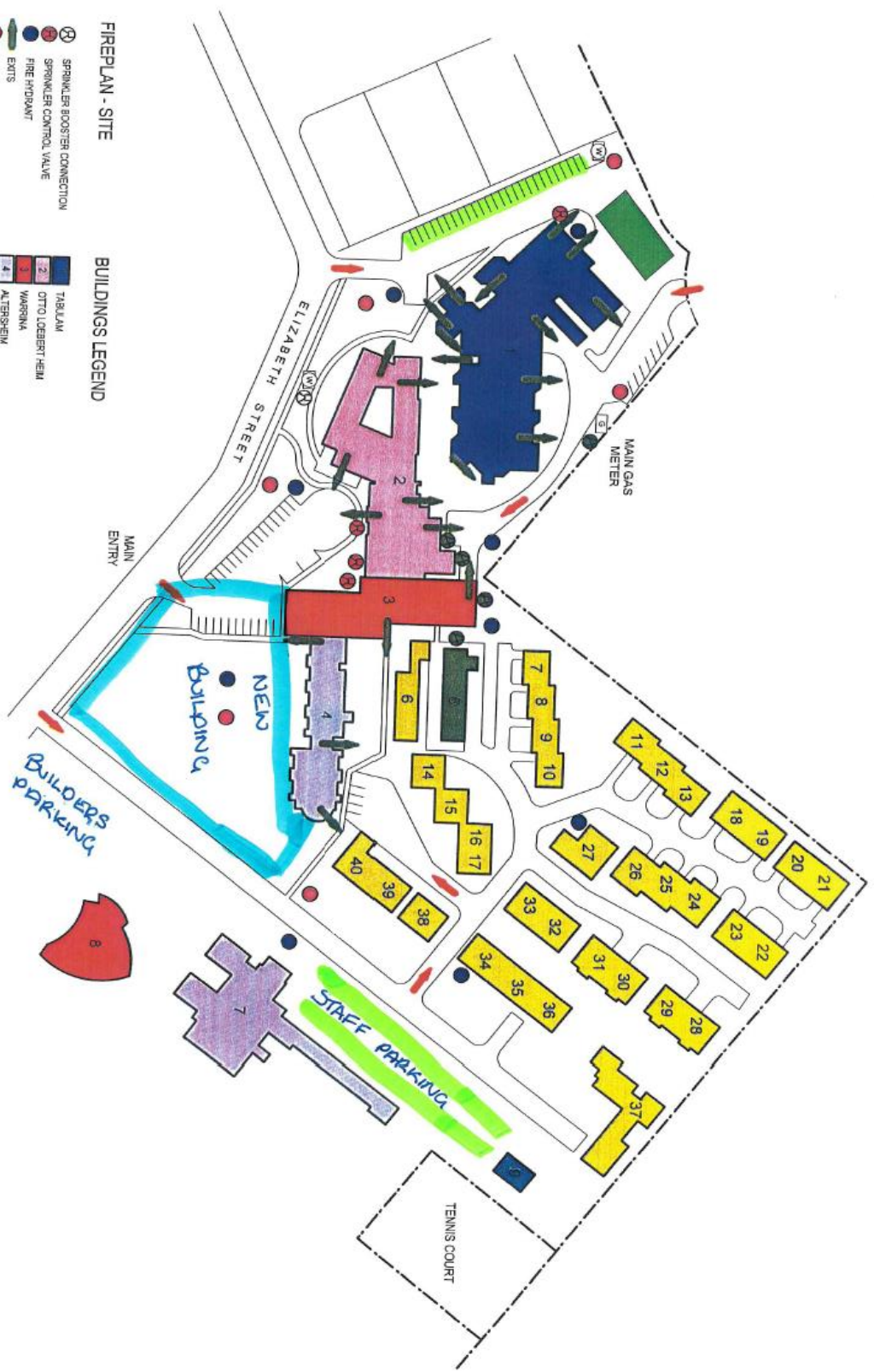

SITE PLAN - 2011 VERSION
 REDEVELOPMENT OF
 TABULAM & TEMPLAR HOMES FOR THE AGED
 31 ELIZABETH ST. BAYSWATER